

NOTES:

- HOLES AND INTERFACE DIMENSIONS PER MIL-PRF-83513/2.
- MATEABLE WITH CONNECTORS MANUFACTURED PER MIL-PRF-83513/1 AND MIL-PRF-83513/3.
- DESIGNED TO BE LASER WELDED TO AN ALUMINUM HOUSING.
- HERMETIC LEAK RATE: LESS THAN OR EQUAL TO 1×10^{-9} CC/SEC He AT 1 ATM DIFFERENTIAL PRESSURE.
- ELECTRICAL REQUIREMENTS:
 INSULATION RESISTANCE: GREATER THAN 5,000 MEGOHMS AT $500 \pm 10\%$ VDC AT 25°C WHEN TESTED IAW MIL-STD-1344, METHOD 3003.
 DIELECTRIC WITHSTANDING VOLTAGE: MUST SHOW NO EVIDENCE OF BREAKDOWN OR FLASHOVER WHEN SUBJECTED TO 600 VAC RMS 60Hz IAW MIL-STD-1344, METHOD 3001. DURATION OF APPLICATION TO BE 1 SEC MIN.

7. MATERIALS:

WELD FLANGE: 4XXX SERIES ALUMINUM.
 CONTACTS: BERYLLIUM-COPPER IAW ASTM B196 OR ASTM B197.
 INSULATORS: KRYOFLEX 313 PROPRIETARY POLYCRYSTALLINE CERAMIC.
 INTERFACIAL SEAL: FLUOROSILICONE RUBBER IAW MIL-R-25988, CLASS I, TYPE II, GRADE 60.
 HELICAL INSERTS: 300-SERIES STAINLESS STEEL.

- FINISH CONTACTS: ELECTROLYTIC NICKEL PLATE IAW QQ-N-290, .000100/.000250 THICK.
 GOLD PLATE IAW ASTM B488, TYPE II, CODE C OR MIL-G-45204, TYPE II, GRADE C, .000050/.000100 THICK.

SHELL: CHEMICAL CONVERSION COATING

9. ORDERING INFORMATION:

PLEASE SPECIFY ACCORDING TO THE FOLLOWING

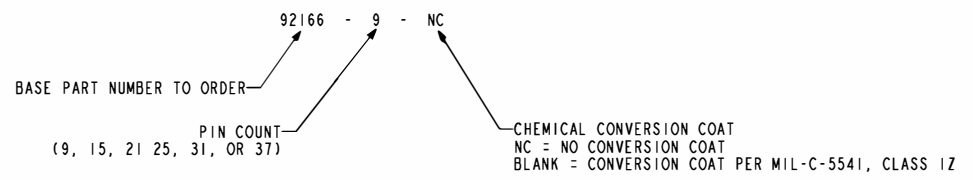
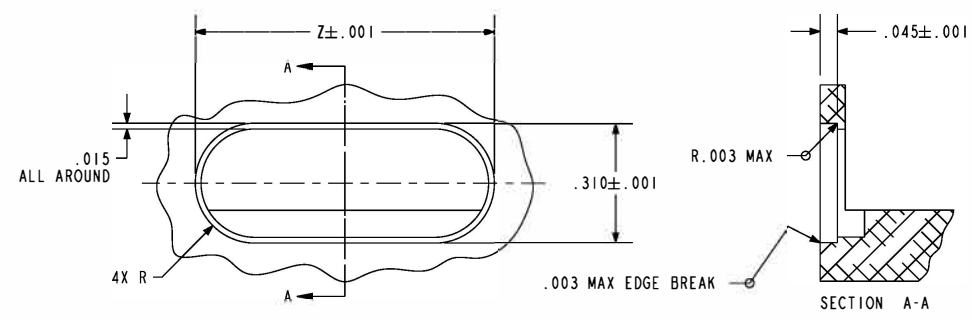

TABLE I

| NUMBER OF CONTACTS | W | Y | Z |
|--------------------|-------|-------|-------|
| 9 | .775 | .452 | .778 |
| 15 | .925 | .602 | .928 |
| 21 | 1.075 | .752 | 1.078 |
| 25 | 1.175 | .852 | 1.178 |
| 31 | 1.325 | 1.002 | 1.328 |
| 37 | 1.475 | 1.152 | 1.478 |



HOLE DETAIL

| | |
|---------|---------------|
| VERSION | RELEASE DATE: |
| G.3 | 01-20-11 |

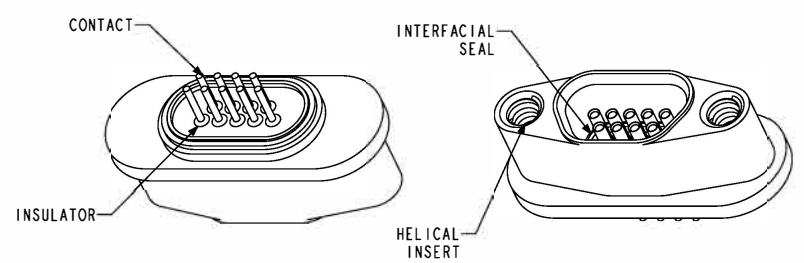
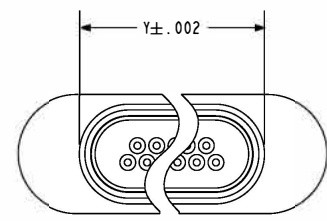
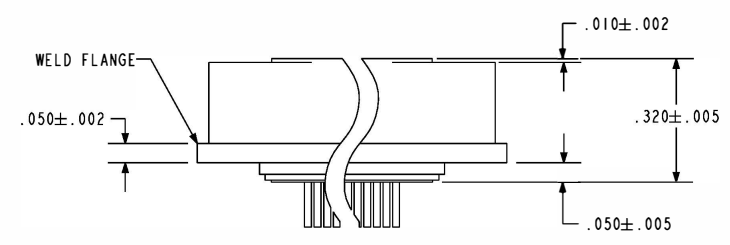
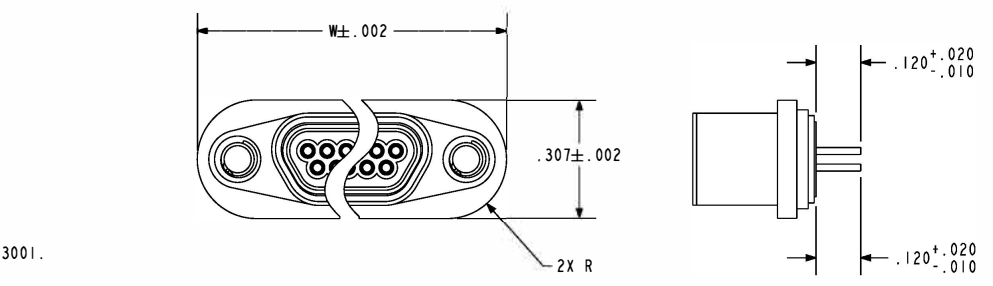

PAC
 A Division of HERMETICSOLUTIONS
 434 Olds Station Rd. Wenatchee WA 98801

WWW.PACAERO.COM

TITLE: CONNECTOR, MICRO-D, AL-COMPATIBLE, STD-PROFILE, W/FLATS

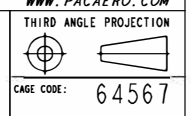

SALES DRAWING

SHEET: 1 OF 1

DOCUMENT: 0-92166