

NOTES:

1. HOLES AND INTERFACE DIMENSIONS PER MIL-PRF-83513/2.
2. MATEABLE WITH CONNECTORS MANUFACTURED PER MIL-PRF-83513/1 AND MIL-PRF-83513/3.
3. DESIGNED TO BE O-RING SEALED AND FASTENED WITH HARDWARE.
4. HERMETIC LEAK RATE: LESS THAN OR EQUAL TO  $1 \times 10^{-8}$  CC/SEC He AT 1 ATM DIFFERENTIAL PRESSURE.
5. ELECTRICAL REQUIREMENTS:  
 INSULATION RESISTANCE: GREATER THAN 5,000 MEGOHMS AT  $500 \pm 10\%$  VDC AT 25°C WHEN TESTED IAW MIL-STD-1344, METHOD 3003.  
 DIELECTRIC WITHSTANDING VOLTAGE: MUST SHOW NO EVIDENCE OF BREAKDOWN OR FLASHOVER WHEN SUBJECTED TO 600 VAC RMS 60Hz IAW MIL-STD-1344, METHOD 3001. DURATION OF APPLICATION TO BE 1 SEC MIN.
6. MATERIALS:  
 SHELL: 304L STAINLESS STEEL.  
 CONTACTS: BERYLLIUM-COPPER IAW ASTM B196 OR ASTM B197.  
 INSULATORS: KRYOFLEX 313 PROPRIETARY POLYCRYSTALLINE CERAMIC.  
 INTERFACIAL SEAL: FLUOROSILICONE RUBBER IAW MIL-R-25988, CLASS I, TYPE II, GRADE 60.  
 MALE-FEMALE HEX STANDOFFS: 300-SERIES STAINLESS STEEL (SHIPPED LOOSE).  
 O-RING: SILICONE OR VITON (SHIPPED LOOSE).
7. FINISHES:  
 CONTACTS: ELECTROLYTIC NICKEL PLATE IAW QQ-N-290, .000050/.000150 THICK.  
 GOLD PLATE IAW ASTM B488, TYPE II, GRADE C OR MIL-G-45204, TYPE II, GRADE C, .000050/.000100 THICK.

8. ORDERING INFORMATION:  
 PLEASE SPECIFY ACCORDING TO THE FOLLOWING:

PA&E PART NUMBER	PINS	W	X	Y	Z
92595-1	9	1.008	0.565	0.3585	0.394
92261-1	15	1.158	0.715	0.5085	0.544
92350-1	21	1.308	0.865	0.6585	0.694
92389-1	25	1.408	0.965	0.7585	0.796
93832-1	31	1.558	1.115	0.9085	0.946
92254-1	37	1.708	1.265	1.0585	1.094

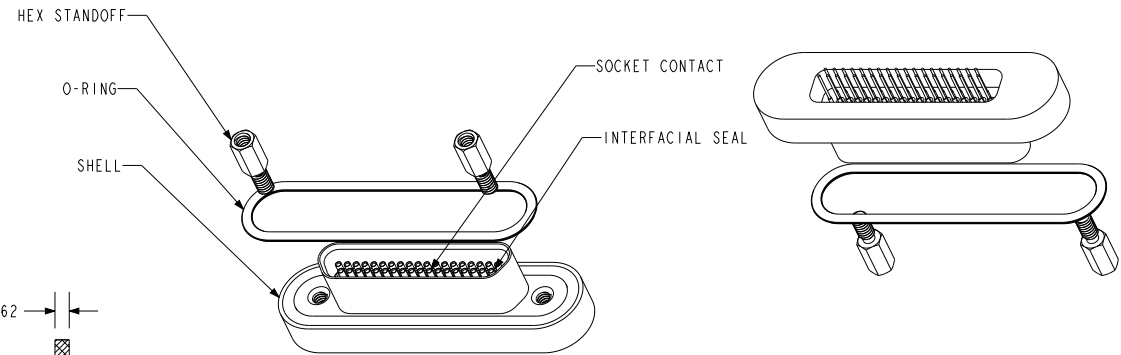
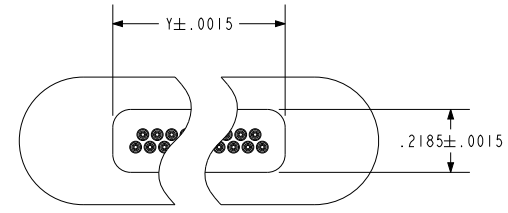
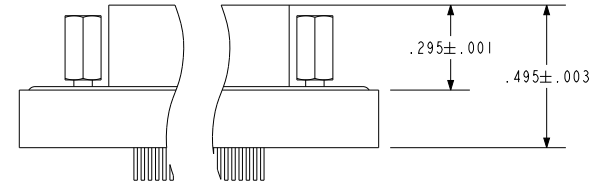
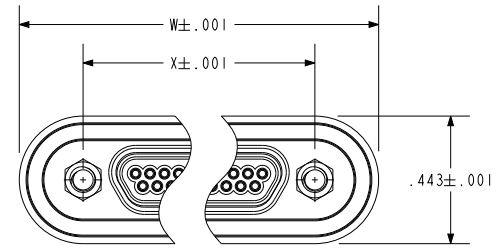

SCALE 1.000  
(92254-1 SHOWN)

SCALE 1.000  
(92254-1 SHOWN)

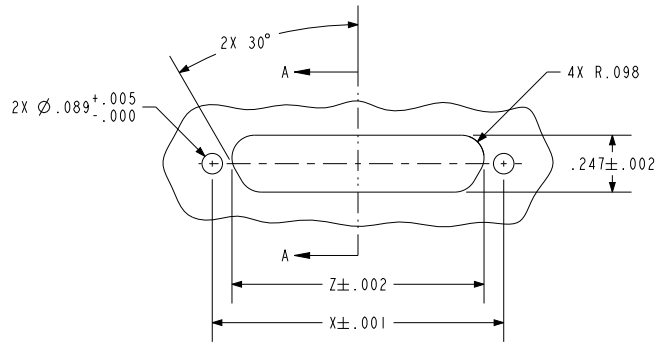

HOLE DETAIL  
 SCALE 1.200  
 (92254-1 SHOWN)

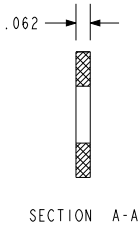

**PA&E**  
 A Division of  
**HERMETICSOLUTIONS**  
 The Hermetic Advantage. Enabling Technology.  
 434 Olds Station Rd. Wenatchee WA 98801

WWW.PACAERO.COM

TITLE: CONNECTOR, MICRO-D, O-RING, STEPPED PIN

THIRD ANGLE PROJECTION  
  
 CAGE CODE: 64567

VERSION: E.1  
 RELEASE DATE: 01-18-08

**SALES DRAWING**

SHEET: 1 OF 1

DOCUMENT: 0-92254