

NOTES:

1. HOLES AND INTERFACE DIMENSIONS PER MIL-PRF-83513/2.
2. MATEABLE WITH CONNECTORS MANUFACTURED PER MIL-PRF-83513/1 AND MIL-PRF-83513/3.
3. DESIGNED TO BE LASER WELDED TO AN ALUMINUM HOUSING.
4. WIRE BOND FLATS TO BE .015 MIN. LONG AND .010 MIN WIDE.
5. HERMETIC LEAK RATE: LESS THAN OR EQUAL TO  $1 \times 10^{-9}$  CC/SEC He AT 1 ATM DIFFERENTIAL PRESSURE.
6. ELECTRICAL REQUIREMENTS:
  - INSULATION RESISTANCE: GREATER THAN 5,000 MEGOHMS AT  $500 \pm 10\%$  VDC AT  $25^\circ\text{C}$  WHEN TESTED IAW MIL-STD-1344, METHOD 3003.
  - DIELECTRIC WITHSTANDING VOLTAGE: MUST SHOW NO EVIDENCE OF BREAKDOWN OR FLASHOVER WHEN SUBJECTED TO 500 VAC RMS 60Hz IAW MIL-STD-1344, METHOD 3001. DURATION OF APPLICATION TO BE 1 SEC MIN.
7. MATERIALS:
  - WELD FLANGE: 4XXX SERIES ALUMINUM.
  - CONTACTS: BERYLLIUM-COPPER IAW ASTM B196 OR ASTM B197.
  - INSULATORS: KRYOFLEX 313 PROPRIETARY POLYCRYSTALLINE CERAMIC.
  - INTERFACIAL SEAL: FLUOROSILICONE RUBBER IAW MIL-R-25988, CLASS I, TYPE II, GRADE 60.
  - THREADED INSERTS: 304L STAINLESS STEEL
8. FINISH:
  - CONTACTS: ELECTROLYTIC NICKEL PLATE IAW QQ-N-290, .000100/.000250 THICK.
  - GOLD PLATE IAW ASTM B488, TYPE III, CODE A OR MIL-G-45204, TYPE III, GRADE A, .000050/.000150 THICK.
9. ORDERING INFORMATION:
  - PLEASE SPECIFY ACCORDING TO THE FOLLOWING:

BASE PART NUMBER TO ORDER  $\nearrow$  93075 - 15  $\nwarrow$  PIN COUNT  
 (9, 15, 21, 25, 31, OR 37)

TABLE I		
NUMBER OF CONTACTS	Y	Z
9	.792	.795
15	.942	.945
21	1.092	1.095
25	1.192	1.195
31	1.342	1.345
37	1.492	1.495

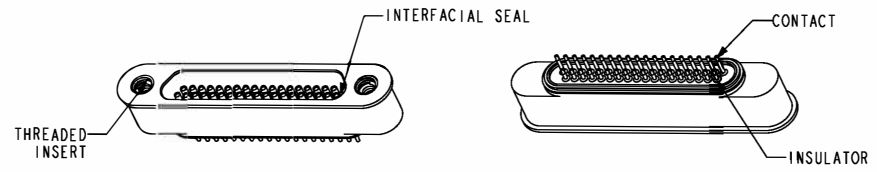
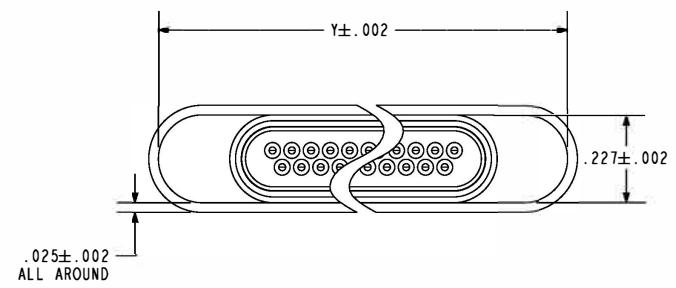
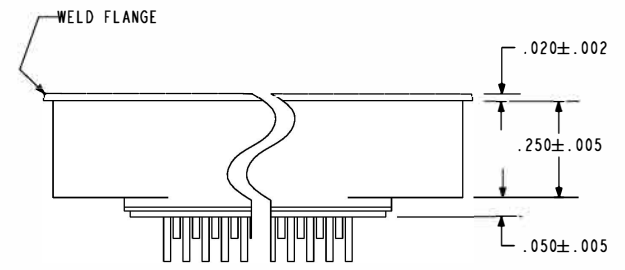
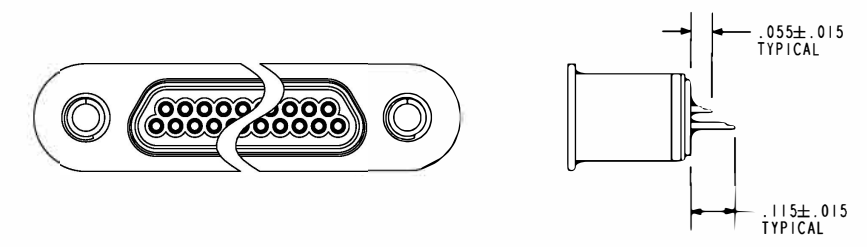
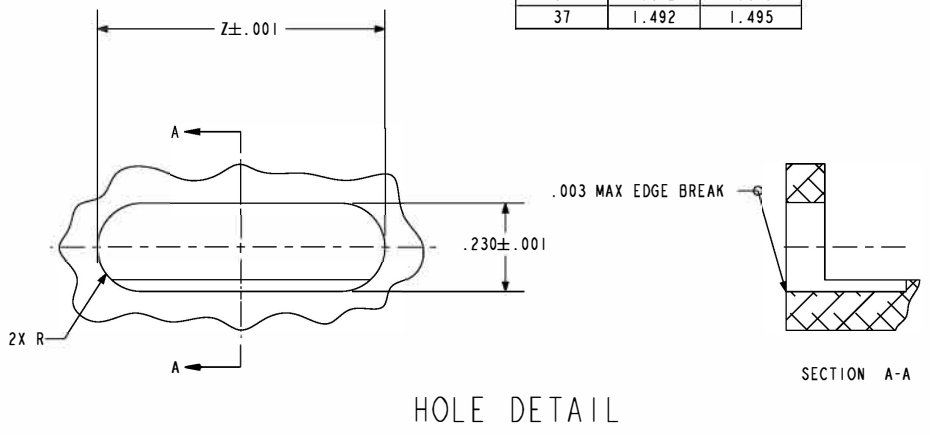

SCALE 1.000  
 - 37 SHOWN

<p>A Division of  <b>HERMETIC SOLUTIONS</b>  <small>Enabling Technology</small></p> <p>434 Olds Station Rd. Wenatchee WA 98801</p>		<p>WWW.PACAERO.COM</p>	
<p>TITLE:                  CONNECTOR, MICRO-D, LOW-PROFILE, AL-COMPATIBLE</p>			<p>THIRD ANGLE PROJECTION</p>
<p>VERSION: G.2</p>		<p>RELEASE DATE: 01-12-11</p>	
<p><b>SALES DRAWING</b></p>		<p>SHEET: 1 OF 1</p>	
<p>DOCUMENT: 0-93075</p>			<p>pro/ENGINEER</p>