

NOTES:

1. HOLES AND INTERFACE DIMENSIONS PER MIL-PRF-83513/2.
2. MATEABLE WITH CONNECTORS MANUFACTURED PER MIL-PRF-83513/1 AND MIL-PRF-83513/3.
3. DESIGNED TO BE LASER WELDED TO A STAINLESS STEEL HOUSING.
4. HERMETIC LEAK RATE: LESS THAN OR EQUAL TO  $1 \times 10^{-9}$  CC/SEC  $H_2$  AT 1 ATM DIFFERENTIAL PRESSURE.
5. ELECTRICAL REQUIREMENTS:
  - INSULATION RESISTANCE: GREATER THAN 5,000 MEGOHMS AT  $500 \pm 10\%$  VDC AT  $25^\circ C$  WHEN TESTED IAW MIL-STD-1344, METHOD 3003.
  - DIELECTRIC WITHSTANDING VOLTAGE: MUST SHOW NO EVIDENCE OF BREAKDOWN OR FLASHOVER WHEN SUBJECTED TO 500 VAC RMS 60 Hz IAW MIL-STD-1344, METHOD 3001. DURATION OF APPLICATION TO BE 1 SEC MIN.

6. MATERIALS:
  - SHELLS: 300-SERIES STAINLESS STEEL
  - CONTACTS: BERYLLIUM-COPPER IAW ASTM B196 OR ASTM B197.
  - INSULATORS: KRYOFLEX 313 PROPRIETARY POLYCRYSTALLINE CERAMIC.
  - INTERFACIAL SEAL: FLUOROSILICONE RUBBER IAW MIL-R-25988, CLASS I, TYPE II, GRADE 60.

7. FINISHES:
  - CONTACTS: ELECTROLYTIC NICKEL PLATE IAW QQ-N-290, .000050/.000100 THICK.
  - GOLD PLATE IAW ASTM-B488, TYPE III, CODE C, .000050/.000100 THICK.

8. ORDERING INFORMATION:
  - PLEASE SPECIFY ACCORDING TO THE FOLLOWING

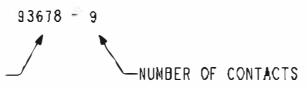
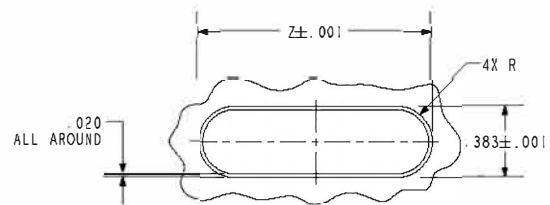
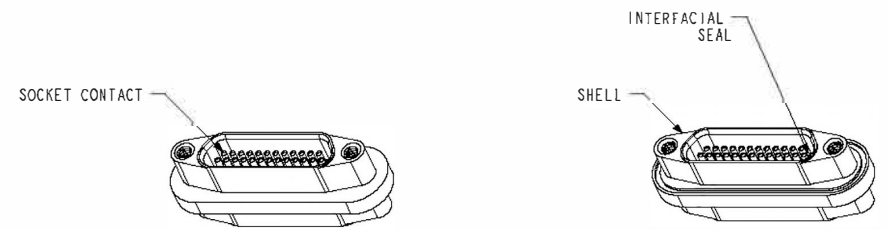
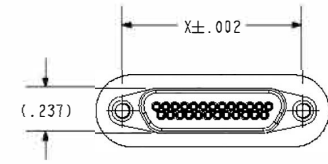
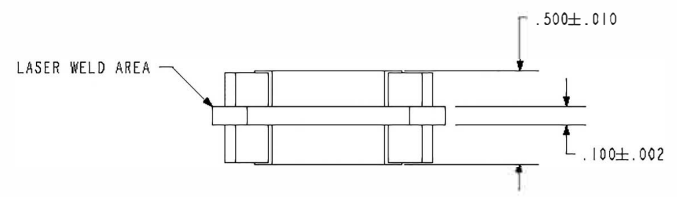
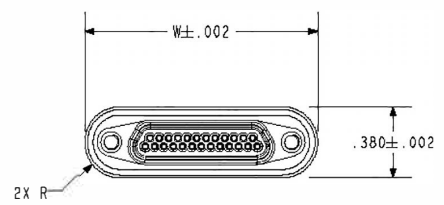
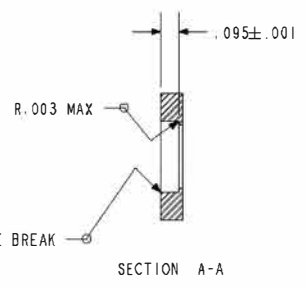

TABLE I				
PART NUMBER	W	X	Z	CONTACTS
93678-9	.848	.565	.851	9
93678-15	.998	.715	1.001	15
93678-21	1.148	.865	1.151	21
93678-25	1.248	.965	1.251	25
93678-31	1.398	1.115	1.401	31
93678-37	1.548	1.265	1.551	37



HOLE DETAIL



SECTION A-A



434 Olds Station Rd. Wenatchee WA 98801

TITLE:	CONNECTOR, MICRO-D, DOUBLE-ENDED
VERSION:	F.0
RELEASE DATE:	02-10-12
SHEET:	1 OF 1
DOCUMENT:	0-93678

WWW.PACAERO.COM  
 THIRD ANGLE PROJECTION  
  
 CAGE CODE: 64567  
 DOCUMENT: 0-93678  
 prg/ENGINEER