

NOTES:

- 1. HOLES AND INTERFACE DIMENSIONS PER MIL-PRF-83513/2.
- 2. MATEABLE WITH CONNECTORS MANUFACTURED PER MIL-PRF-83513/1 AND MIL-PRF-83513/3.
- 3. DESIGNED FOR LASER WELDING TO AN ALUMINUM HOUSING.
- 4. HERMETIC LEAK RATE: LESS THAN OR EQUAL TO 1×10^{-9} CC/SEC H_2 AT 1 ATM DIFFERENTIAL PRESSURE.
- 5. ELECTRICAL REQUIREMENTS:

INSULATION RESISTANCE: GREATER THAN 5,000 MEGOHMS AT $500 \pm 10\%$ VDC AT $25^\circ C$ WHEN TESTED IAW MIL-STD-1344, METHOD 3003.

DIELECTRIC WITHSTANDING VOLTAGE: MUST SHOW NO EVIDENCE OF BREAKDOWN OR FLASHOVER WHEN SUBJECTED TO 600 VAC RMS 60Hz IAW MIL-STD-1344, METHOD 3001. DURATION OF APPLICATION TO BE 1 SEC MIN.

6. MATERIALS:

WELD FLANGE: 4XXX SERIES ALUMINUM.
 CONTACTS: BERYLLIUM-COPPER IAW ASTM B196 OR ASTM B197.
 INSULATORS: KRYOFLEX 313 PROPRIETARY POLYCRYSTALLINE CERAMIC.
 INTERFACIAL SEAL: FLUOROSILICONE RUBBER IAW MIL-R-25988, CLASS I, TYPE II, GRADE 60.
 HELICAL INSERTS: 300-SERIES STAINLESS STEEL.
 WIRE: 26 AWG PER M22759.

7. FINISH:

CONTACTS: ELECTROLYTIC NICKEL PLATE IAW QQ-N-290, .000100/.000250 THICK.
 GOLD PLATE IAW MIL-G-45204, TYPE II, GRADE C, .000050/.000150 THICK.

SHELL: CHEMICAL CONVERSION COAT IAW MIL-C-5541, CLASS IA.

8. ORDERING INFORMATION:

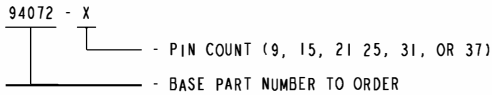
PLEASE SPECIFY ACCORDING TO THE FOLLOWING: 94072 - X

| TABLE I | | | |
|--------------------|-------|-------|-------|
| NUMBER OF CONTACTS | W | Y | Z |
| 9 | .775 | .453 | .778 |
| 15 | .925 | .603 | .928 |
| 21 | 1.075 | .753 | 1.078 |
| 25 | 1.175 | .853 | 1.178 |
| 31 | 1.325 | 1.003 | 1.328 |
| 37 | 1.475 | 1.153 | 1.478 |

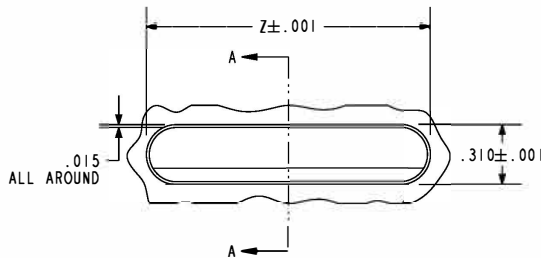

HOLE DETAIL

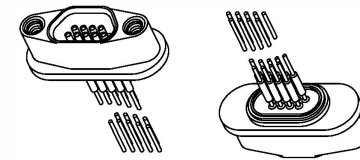
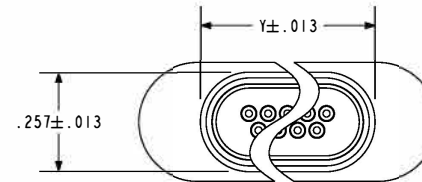
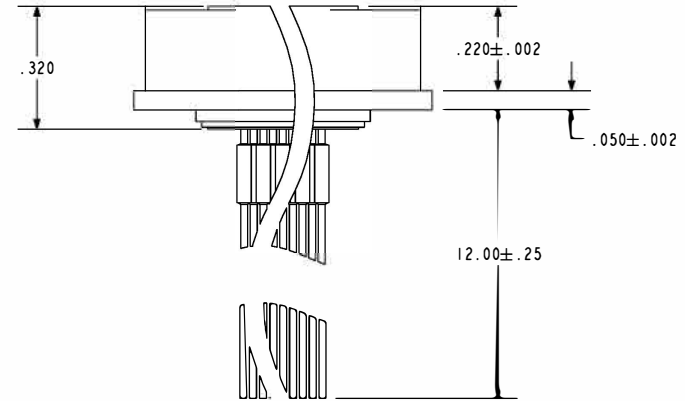
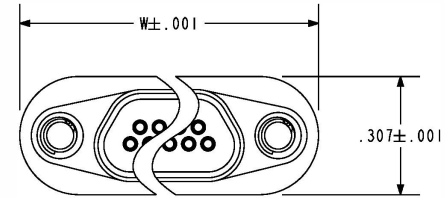
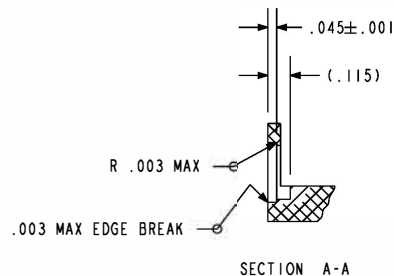

SCALE 1.000
 (-9 SHOWN)

PA&E A Division of HERMETIC SOLUTIONS
 434 Olds Station Rd. Wenatchee WA 98801

TITLE: CONNECTOR, MICRO-D, AL-COMPATIBLE, FLANGED, WIRED

WWW.PACAERO.COM

THIRD ANGLE PROJECTION



CAGE CODE: 64567

VERSION: A.1

RELEASE DATE: 09-14-11

SALES DRAWING

SHEET: 1 OF 1

DOCUMENT: 0-94072