

NOTES:

THESE PRODUCTS ARE SUBJECT TO THE INTERNATIONAL TRAFFIC IN ARMS REGULATIONS ("ITAR"), AND MAY NOT BE RESOLD, DIVERTED, TRANSFERRED, SHIPPED, OR OTHERWISE BE DISPOSED OF IN ANY OTHER COUNTRY, EITHER IN THEIR ORIGINAL FORM OR AFTER BEING INCORPORATED THROUGH AN INTERMEDIATE PROCESS INTO OTHER END ITEMS, WITHOUT THE PRIOR WRITTEN APPROVAL OF THE U.S. DEPARTMENT OF STATE. IN ADDITION, RELATED TECHNICAL DATA MAY NOT BE DISCLOSED, EXPORTED OR TRANSFERRED IN ANY MANNER TO ANY FOREIGN NATIONAL OR ANY FOREIGN COUNTRY WITHOUT PRIOR WRITTEN APPROVAL OF THE DIRECTORATE OF DEFENSE TRADE CONTROLS, U.S. DEPARTMENT OF STATE.

- 1. HOLE DIMENSIONS PER PAE-40458.
- 2. DESIGNED TO MATE WITH PAE JR-D RECEPTACLE CONNECTORS.
- 3. ELECTRICAL REQUIREMENTS:

INSULATION RESISTANCE: GREATER THAN 5,000 MEGOHMS AT 500±10% AT 25°C WHEN TESTED IAW MIL-STD-1344 METHOD 3003.

DIELECTRIC WITHSTANDING VOLTAGE: MUST SHOW NO EVIDENCE OF BREAKDOWN OR FLASHOVER WHEN SUBJECTED TO 600 VAC RMS 60Hz IAW MIL-STD-1344, METHOD 3001. DURATION OF APPLICATION TO BE 1 SEC MIN.

- 4. MATERIALS:
  - SHELL EXPLOSION BONDED STAINLESS STEEL TO 4XXX-SERIES ALUMINUM.
  - CONTACTS: BERYLLIUM-COPPER IAW ASTM B196 OR ASTM B197.
  - INSULATIONS: KYROFLEX 313 PROPRIETARY POLYCRYSTALLINE CERAMIC.
  - INTERFACIAL SEAL: FLOUROSILICONE RUBBER IAW MIL-R-25988, CLASS I, TYPE II, GRADE 60.
  - HELICAL INSERTS: 300-SERIES STAINLESS STEEL.

- 5. ORDERING INFORMATION:

PLEASE SPECIFY ACCORDING TO THE FOLLOWING:

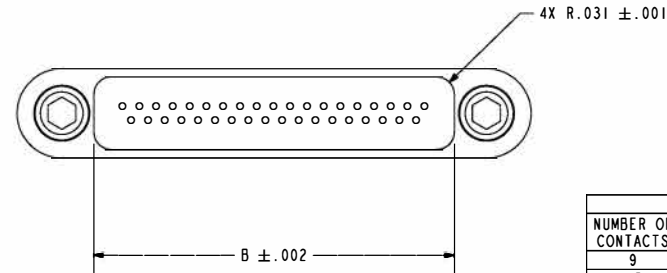
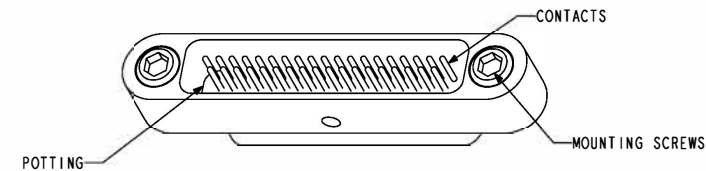
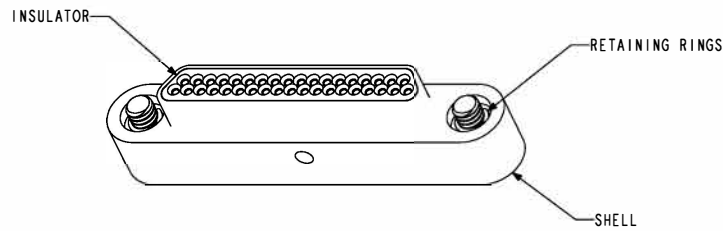
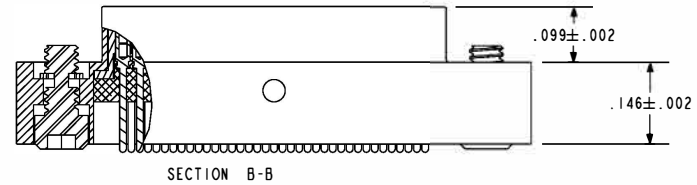
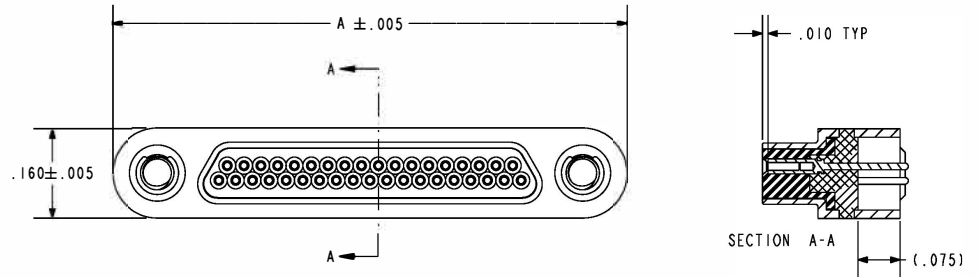
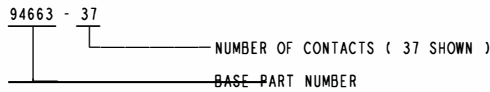

TABLE I		
NUMBER OF CONTACTS	A	B
9	.500	.225
15	.590	.315
21	.680	.405
25	.740	.465
31	.830	.555
37	.920	.645
51	1.130	.855

SCALE 2.500  
94663-37 SHOWN

**PAE**  
The Hermetic Advantage  
A Division of  
**HERMETICSOLUTIONS**  
Enabling Technology  
434 Olds Station Rd. Wenatchee WA 98801

WWW.PACAERO.COM

TITLE:

CONNECTOR, RG, JR-D, PLUG

THIRD ANGLE PROJECTION

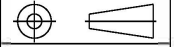

CAGE CODE: 64567

VERSION  
B.0

RELEASE DATE:  
09-16-11

SALES DRAWING

SHEET:  
1 OF 1

DOCUMENT:  
0-94663