

NOTES:

1. DESIGNED TO BE LASER WELDED TO A TITANIUM HOUSING.
2. HERMETIC LEAK RATE: LESS THAN OR EQUAL TO  $1 \times 10^{-9}$  CC/SEC  $H_2$  AT 1 ATM DIFFERENTIAL PRESSURE.
3. ELECTRICAL REQUIREMENTS:  
 INSULATION RESISTANCE: GREATER THAN 5,000 MEGOHMS AT  $500 \pm 10\%$  VDC AT 25°C WHEN TESTED IAW MIL-STD-1344, METHOD 3003.  
 DIELECTRIC WITHSTANDING VOLTAGE: MUST SHOW NO EVIDENCE OF BREAKDOWN OR FLASHOVER WHEN SUBJECTED TO 600 VAC RMS 60Hz IAW MIL-STD-1344, METHOD 3001.  
 DURATION OF APPLICATION TO BE 1 SEC MIN.
4. MATERIALS:  
 WELD FLANGE: GRADE 4 TITANIUM  
 CONTACTS: 80%Pt/20%Ir  
 INSULATOR: KRYOFLEX 313 PROPRIETARY POLYCRYSTALLINE CERAMIC.  
 CAP BEAD: ALUMINA
5. ORDERING INFORMATION:

PLEASE SPECIFY ACCORDING TO THE FOLLOWING

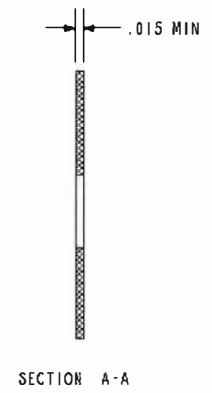
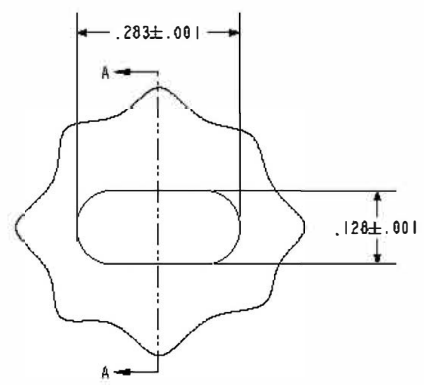
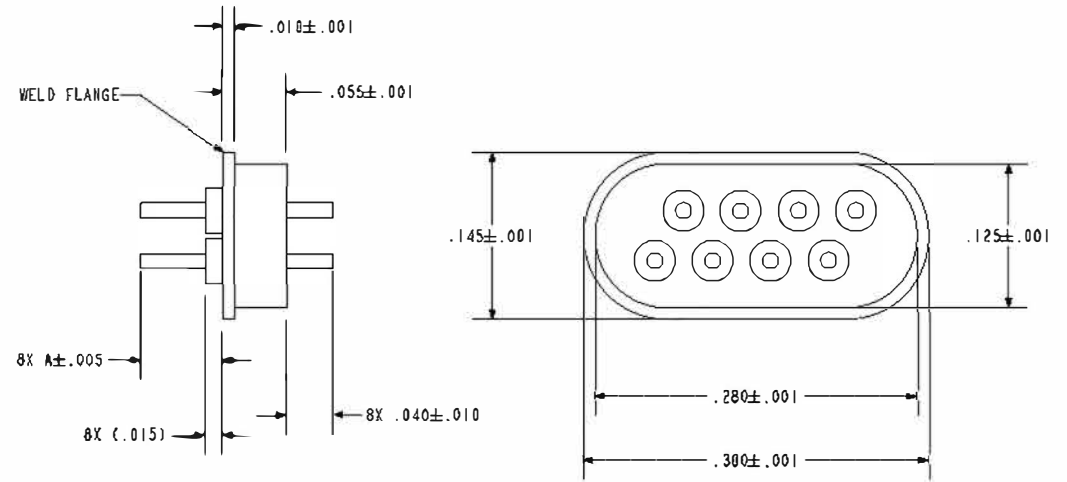
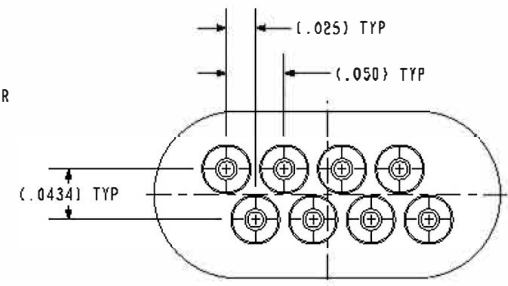

SUGGESTED HOLE DETAIL

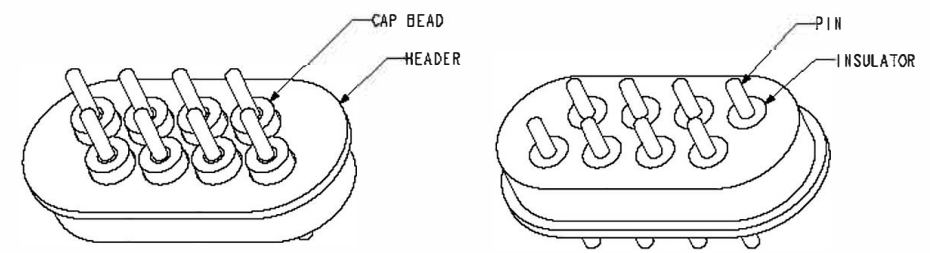

SCALE 1.000  
 95023-1-071 SHOWN

434 Olds Station Rd. Wenatchee WA 98801			
TITLE:		THIRD ANGLE PROJECTION	
FEEDTHRU, IMPLANTABLE, TWO ROW, .050 PITCH (8-PIN)			
J/C:		<b>EAR</b>	
VERSION	RELEASE DATE:	CAGE CODE:	SHEET:
A.0	02-06-14	64567	1 OF 1
<b>SALES DRAWING</b>		SCALE:	DOCUMENT:
		6.000	0-95023